

MissingLink Guide



How to Install MissingLink (NON RE-USABLE)

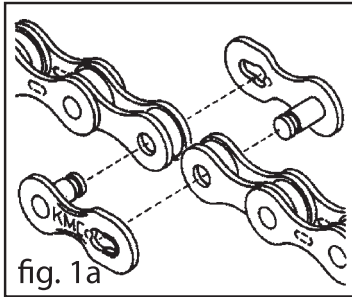

fig. 1a

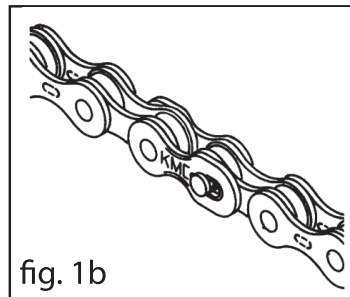

fig. 1b

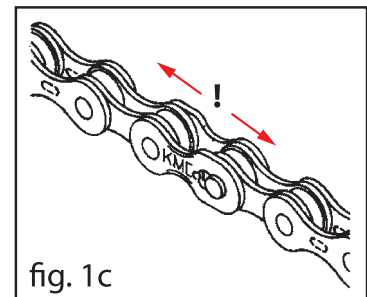

fig. 1c

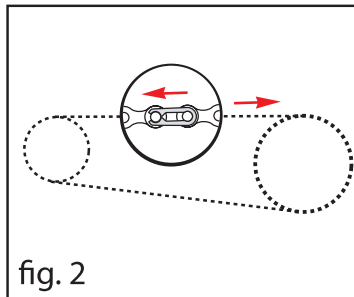

fig. 2

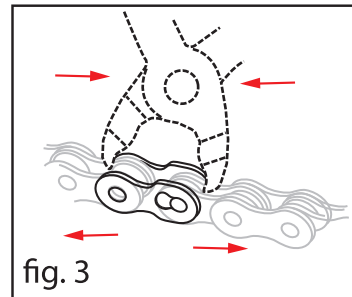

fig. 3

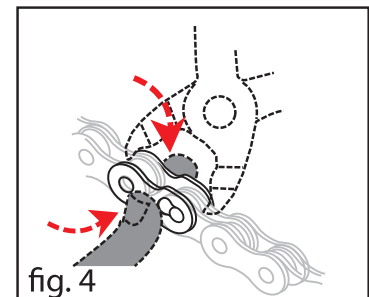



fig. 4

MissingLink Connector

1. Insert pin link opposite to each other into both chain ends (fig. 1.a.)
2. Engage pin links into each other's elongated slots (fig. 1.b.)
3. Use KMC MissingLink Connector tool to lock link plates into place (fig.3)
4. Alternate instructions:
 - 4.1. Insert pin link opposite to each other into both chain ends (fig.1.a.)
 - 4.2. Engage pin links into each other's elongated slot (fig. 1.b.)
 - 4.3. Rotate chain so MissingLink is positioned on top of the chain (fig.2)
 - 4.4. Pedal forward, while retaining wheel in place. The pedal force will lock MissingLink in position (audible click) (fig .c.)
5. Removal:
Use KMC "MissingLink Remover" tool to open (fig.4)

Caution: Always use a new MissingLink when fitting a new chain.
Failure to shorten the chain properly or to lock exactly into place may cause damage or the rider to fall off his bicycle resulting into injury

 Do not re-use chain pins after pin removal. Reconnect chain using a proper KMC connecting link.



For your own safety, do not reuse chain pins after pin removal. Please reconnect chain using a KMC connecting link.

BICYCLE CHAIN

WWW.KMCCHAIN.US